



**Acme Sanitary Ware Co. Ltd.**

1/F, Acme Building, 22-28 Nanking Street, Kowloon, Hong Kong

Tel: 2388 7171 Fax: 2710 8012

Email: acme@acmesanitary.com.hk

Website: www.acmesanitary.com.hk

**stern**

PROJECT		REF		REV	ITEM CODE	
LOCATION		DATE			PAGE	

## SANITARY WARE SPECIFICATION SHEET

Item Descriptions	Stern (Israel) "Elite 1000" Chrome plated deck mounted sensor mixer with adjustable temperature limiter in AC Supply with 5m wire AC 110-240 Vac 50/60Hz to 9V 0.3A <b>IP68 waterproof switching transformers</b>	Illustration/ Drawing
Dimensions	L88 x W44 x H142 mm	
Model	Elite 1000 E	
Code Number	236800	
Finish	Chrome Plated	
Supplier	Acme Sanitary Ware Co. Ltd	
Contact Tel/Fax	Mr. Eric Wong/ Mr. Don Yuen (852) 2388-7171 / (852) 2710-8012	
E-mail	acme@acmesanitary.com.hk	
Website	www.acmesanitary.com.hk	

### ELITE 1000 E Ref # 236800

Touch-free electronic faucet for deck-mounted installations. Activated by infrared sensor. For hot and cold water. Includes a mixer for water temperature adjustment and filters. Chrome plated body, other finishes available. The latching solenoid valve is located above deck inside the product for added vandal protection. regular faucet Installation with simple transformer connection. Adjustable setting by remote control: sensor range, security time, delay in, delay out, on-off and reset to factory setting. 24 hours mandatory hygiene flush available upon request.

#### Application:

Deck-mounted faucet. Combining an elegant minimalist design with anti-vandal features. Easy installation. Long lasting even in the harshest installation sites. Helps washrooms to stay clean and saves water. Prevents cross contamination. Ideal for stadiums, train and bus stations and highway rest stops.

#### Use:

Touch-free electronic faucet. The faucet is activated automatically when the users place their hands in the sensor range and stops when the users remove their hands.

#### PRODUCT AT A GLANCE

Installation	Lavatory mounted
Power Supply	<ul style="list-style-type: none"> <li>9V external battery box • IP67 Battery Box for 6 AA 1.5V alkaline batteries</li> <li>9V Transformer • IP 68 Encapsulated 9V transformer</li> </ul>
Operating pressure	0.5-8.0 bar / 7.0-116.0 PSI
Water supply	Hot and cold water
Water flow	2 lpm / 0.5 gpm
Water temperature	70°C Maximum
Security Time	90 seconds. Adjustable by remote control

#### ORDERING INFORMATION

MODEL	CODE	POWER	ADDITIONAL SPECIFICATIONS
ELITE 1000 B	236700	9V battery	With mixer for water temperature adjustment
ELITE 1000 E	236800	9V transformer	
ELITE 1000 LB	236550	9V battery	Long spout length 138mm \ 5.44"
ELITE 1000 LE	236650	9V transformer	With mixer for water temperature adjustment
ELITE 1000 PLUS B	236750	9V battery	Tall body 338mm \ 13.30" for counter top wash basins
ELITE 1000 PLUS E	236850	9V transformer	With mixer for water temperature adjustment

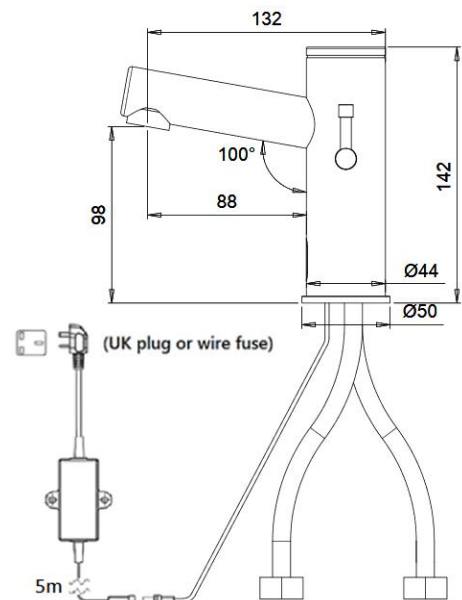

#### Installation:

Lavatory mounted



#### Water supply:

Hot & Cold (2 inlets)



#### Water temperature:

Max 70 °C



#### Operating pressure:

0.5 - 8.0 bar



#### Power source:

9V transformer



#### Stern Soap & Water:

Elite matching soap dispenser



#### Lead free:

Elite 1000E AB1953

\* All information of the above is for the reference only. No prior notice is made if any changes.



## SPARE PARTS LIST

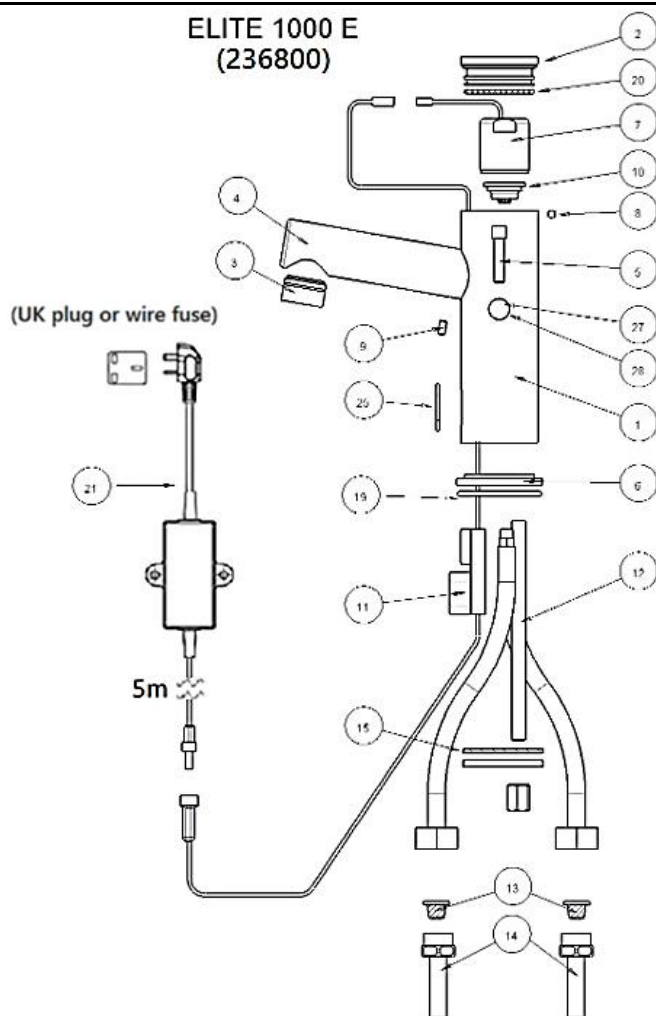

Quantity	Part Number	Description	Cat. No.
-	-	<b>Seals and Screws Kit</b>	<b>07210007</b>
1	20	O-ring	
1	19	O-ring	
1	25	O-ring	
1	15	Gasket	
1	8	Screw	
1	9	Screw	
-	-	<b>Sensor Kit</b>	<b>07220184</b>
1	11	Infra Red Sensor	
1	25	O-ring	
-	-	<b>Filter Adapter Kit</b>	<b>07212001</b>
1	13	Filter	
1	14	Nipple	
-	-	<b>Cover Kit</b>	<b>07270003</b>
1	2	Cover	
1	20	O-ring	
-	-	<b>Solenoid Valve Kit</b>	<b>07230003</b>
1	7	Solenoid valve	
1	10	Diaphragm	
-	10	<b>Diaphragm</b>	<b>04500001</b>
-	-	<b>Mixer Handle kit</b>	<b>07260002</b>
1	5	Handle	
1	27	Axis	
1	28	O-ring	
-	21	<b>Transformer</b>	<b>TBC</b>

**Note:** In order to locate the relevant spare part, please check the corresponding parts and part number in the drawing. Minimum order quantity will be required.

\* All information of the above is for the reference only. No prior notice is made if any changes.



## INSTALLATION

### STEP 1 – PREPARATION FOR MOUNTING THE FAUCET

1

Shut off the water supply.



2

Remove the hexagonal nut, the disk and the gasket. Do not remove the O-ring from the base of the faucet.

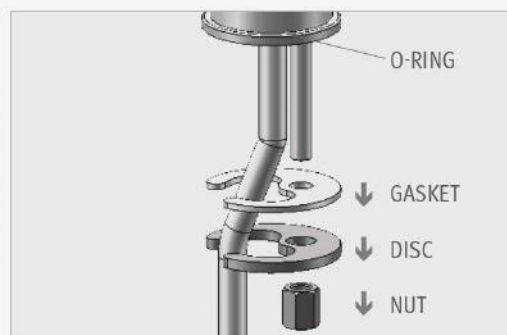

### STEP 2 – INSTALLING THE FAUCET

1

Place the faucet with O-ring into the hole in deck or lavatory. Make sure the O-ring is located between the deck or lavatory and the bottom of the faucet.

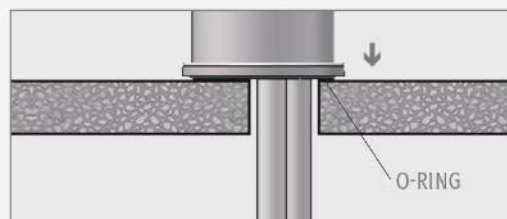

2

Slide the gasket, disk and hexagonal nut over the flexible hose and secure the faucet into place.

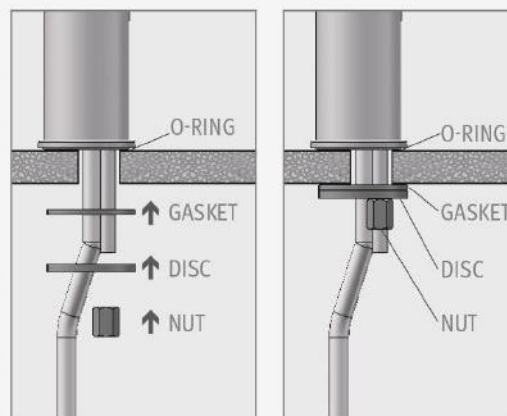



Since 1949

**Acme Sanitary Ware Co. Ltd.**

1/F, Acme Building, 22-28 Nanking Street, Kowloon, Hong Kong

Tel: 2388 7171 Fax: 2710 8012

Email: [acme@acmesanitary.com.hk](mailto:acme@acmesanitary.com.hk)

Website: [www.acmesanitary.com.hk](http://www.acmesanitary.com.hk)

**stern**

## INSTALLATION

### STEP 3 – CONNECTING THE WATER SUPPLY

1

Connect the flexible pipe to the water supply.

*For models with temperature control connect the red flexible pipe to the hot water supply and the blue flexible pipe to the cold water supply.*



2 INLETS VERSION



1 INLET VERSION

**MAKE SURE THAT THE FILTER(S) IS/ARE INSTALLED BETWEEN THE FLEXIBLE PIPE AND THE SHUT OFF VALVE (ANGLE VALVE) (NOT SUPPLIED).**

2

Turn on the central water supply and the shut-off valves (angle valves) and check for leaks.

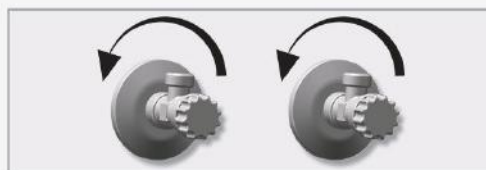





Since 1949

**Acme Sanitary Ware Co. Ltd.**

1/F, Acme Building, 22-28 Nanking Street, Kowloon, Hong Kong

Tel: 2388 7171 Fax: 2710 8012

Email: acme@acmesanitary.com.hk

Website: www.acmesanitary.com.hk

**stern**

## INSTALLATION

### STEP 4 – CONNECTING THE POWER SOURCE

1

#### BATTERY VERSION

Install the battery box at the wall underneath the sink using the two sided adhesive foam tape. The cable connection must point down. (You can use an optional extension cable in order to assemble the battery box up to 10ft. away from the sink.)



2

#### TRANSFORMER VERSION

Plug the transformer into the electricity socket and connect the connectors.



In order to avoid entering into the adjusting mode, wait 10 seconds before operating the faucet. If the range is unsatisfactory, refer to the section titled “settings adjustment.



ABOUT  
**10**  
SECONDS

NOTE: This model includes a special aerator that allows you to adjust the water stream direction on site in order to prevent water splashing if needed. To change the angle of the water stream, simply move the adjustable tilting plate by pressing it smoothly.

**ATTENTION!** the aerator is tightened to prevent removal by hand.





## TROUBLESHOOTING

PROBLEM	INDICATOR	CAUSE	SOLUTION	
No water coming out of the faucet:	1. Sensor flashes continuously when user's hands are within the sensor's range.	Low battery.	Replace battery	
	2. LED in the sensor does not flash once when user's hands are within the sensor's range.	1. Range is too short.	Increase the range	
		2. Range is too long.	Decrease the range	
		3. Battery is completely used up	The battery must be replaced.	
		4. Unit is in "Security Mode"*		
		5. Sensor is picking up reflections from the washbasin or another object.	Eliminate cause of reflection.	
	3. LED in the sensor flashes once when user's hands are within the sensor's range.	1. Connectors between the electronic unit and solenoid are disconnected.	Connect the electronic unit connectors to the solenoid.	
		2. Debris or scale in solenoid.	Unscrew solenoid, pull out the plunger and the spring from the solenoid and clean them. Use scale remover material if needed. When replacing the plunger, please make sure that the spring is in vertical position.	
		3. The central orifice in the diaphragm is plugged or the diaphragm is torn	Clean the orifice or replace diaphragm.	
4. The water supply pressure is higher than 8 bar.		Reduce the supply water pressure.		
Water flow from spout does not stop:	1. Sensor flashes once when user's hands are within the sensor's range.	Debris or scale in diaphragm	Clean the orifice or replace diaphragm.	
	2. LED in the sensor does not flash once when user's hands are within the sensor's range.	1. Sensor is dirty or covered.**	Clean or eliminate cause of interference.	
		2. Sensor is picking up reflections from the washbasin or another object.	Decrease the range or eliminate cause of reflection.	
	Water flow diminished		Filter or aerator is clogged	Remove, clean, re-install

\* "Security Mode": If the sensor is covered for more than 90 sec. the faucet will automatically shut off water flow. To return to normal operation remove any blockage.

\*\* In this case, the water flow will stop anyway after 90 seconds because of the security time.



Supplies Department

打道七號入境事務大樓 48 樓

igration Tower, 7 Gloucester Road, Wan Chai, Hong Kong

本署檔號 : (4) in WSD 3321/2022 T/J(244/2022)  
Our ref.  
來函檔號 :  
Your ref.

電話 :  
Tel.  
傳真 : 2824 0578  
Fax.

13 April 2022

### Approval of "STERN" Sensor Tap (General Acceptance No. B20220006)

Your letters ref. HX/W/0531/22 and HX/W/0900/22 dated 7 March 2022 and 28 March 2022 respectively refer.

It is noted that the fitting described below has been accepted by the United Kingdom Water Regulations Advisory Scheme (WRAS) to have complied with the requirements of the United Kingdom Water Supply (Water Fittings) Regulations / Scottish Water Byelaws when correctly installed. This Authority accepts that the fitting described below based on the WRAS certificate and test report ref. J27475A issued on 21 February 2022 by Nutek Systems (HK) Ltd. complies with, and its use when correctly installed does not contravene, the Waterworks Ordinance and Regulations.

**Name of Manufacturer:** Y Stern Engineering (1989) Ltd

**Country of Origin:** Israel

**Brand:** Stern

**Details of Fitting:** Range of single hole, single outlet (fixed) electronically controlled, tap assemblies (chromium plated brass). Flow is controlled via solenoid valves, actuated by infra-red sensors. Temperature is manually blended using a single





lever operating member. Maximum working pressure 8.0 bar. Maximum operating temperature 60°C.

**Model:** Elite 1000E

**Size:** 3/8"

**Body Markings:**  on top of body

**WRAS Approval Number:** 1808700

**Installation Requirements:** R001, R006, R009  
(Appendix A of WRAS approval letter refers)

**Expiry Date:** 31 August 2023

In view of the acceptance by WRAS, this Authority has no objection to the use of the said fitting in fresh water plumbing systems subject to full adherence to Waterworks installation requirements. In particular, you are required to draw your customers' attention to the following installation requirements –

“Installation shall comply with the ‘Installation Requirements & Notes’ of the WRAS’s approval letter concerned.”

“A stop cock or gate valve must be installed at the upstream of the fitting for manual isolation of water supply.” AND

“The main voltage operated sensor valve should comply with the electricity safety regulation for applications in bathroom, toilet etc.”

A condition of this acceptance is that the fitting to be installed should be replicas of the sample certified by WRAS and no modification should be made to the fitting. This acceptance may be withdrawn at any time if the standard of the fitting installed fails to meet that of the approved sample or if the fitting is found to be unsuitable for use in fresh water plumbing systems.

This acceptance is only applicable to the main body of the fitting, unless otherwise specified.

For the use of the fitting in any project, the General Acceptance Number of this letter must be quoted as a means of identification of acceptance of the fitting by this Authority.



Should you have any enquiries, please contact our Engineer Ms Winnie LO at tel. no. 3583 4086.

Yours faithfully,



(YAU Hau Yin)  
for Director of Water Supplies

Encl.

c.c.      WSD 3321/1/82    ] - without catalogue  
             ME/MC            ] - with soft copy only